



ACCESSORIES FOR BOATS





BORIKA

since  1999

BORIKA is a Ukrainian manufacturer of thermoplastic products for special purposes with 15 years of experience. The company produces plastic products of its own design for various applications. A significant part of the product model range is presented by the proprietary design of BORIKA engineers, which is confirmed by more than 30 international patents.

The production team constantly introduces innovative technologies of product development and improves the manufacturing methods to ensure that products can satisfy the highest requirements. Thanks to consistently high quality, extensive functionality and excellent consumer properties of products BORIKA earned a reputation as a progressive manufacturer and reliable partner. As a result, the company's products are in demand both on domestic and foreign markets. For instance, accessories for water transport which produced under the FASTen trade mark are successfully exported to European countries for more than 5 years.

Accumulated experience of designers and engineers, advanced equipment, adoption of the results of products' field testing, tracking of current global industry trends and participating in numerous international exhibitions - all of this confirms the exceptional status of BORIKA as a leading domestic manufacturer in its market segment.

VITALIY BORISENKO
CEO and Founder of BORIKA





BOAT &
YACHT



RIB



ATV &
MOTO



FISHING
KAYAK



SUP
BOARD

Universal mount

This unique mounting device allows for a quick and easy installation of the entire range of the FASTen® accessories on a watercraft. This universal mount offers exciting possibilities for equipping watercrafts of any type. It allows you to securely mount holders for rods, sonars, cameras and other accessories. It makes it possible to fix an awning, ladder, paddle, rope, anchor lock, navigation lights and other necessary equipment.

Devices and accessories installed in a watercraft with the help of the FASTen® universal mount can be easily removed and swapped.

The FASTen® mounting system is patented and has a number of advantages over foreign counterparts.

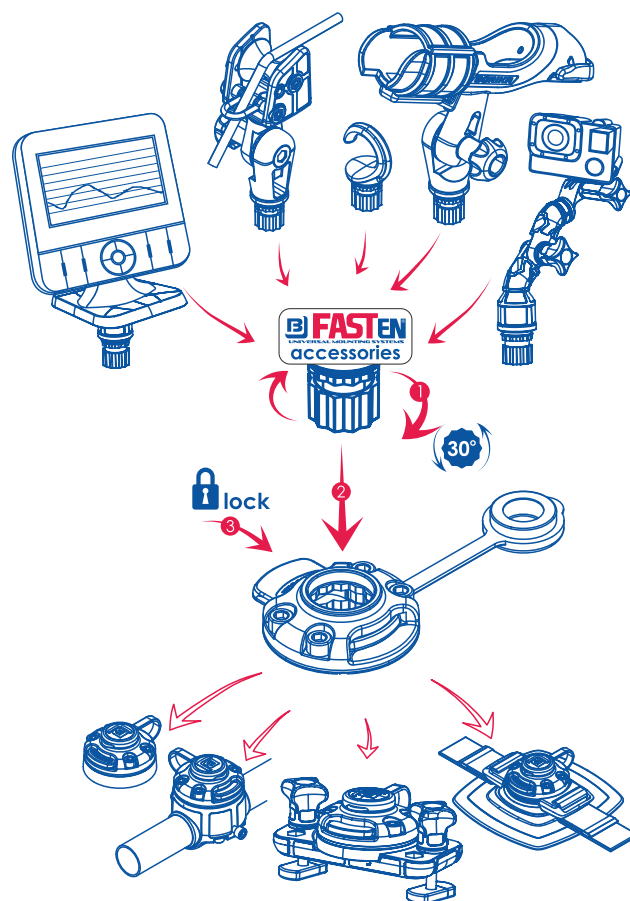

Fast
fixing

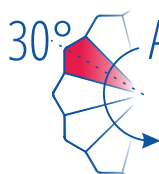

30° Angle
rotation



Three color
combinations

Fs219 Universal mount for accessories

1.01.001.01.01
1.01.001.01.02
1.01.001.01.03

61*61*35 mm

128 g

It is easy to install. With the use of special mounting platforms it can be installed on various types of surfaces - inflatable or hard side, tubular rail or C-shaped track of yachts and boats. It can also be fitted in a Ø32 mm pre-drilled hole in a hard side.



FMb Mount with platform

for installation on hard surface (aluminium, plastic or wooden)

1.01.002.01.01
1.01.002.01.02
1.01.002.01.03

63*63*41 mm

159 g

The mounting platform of the set is attached to a side in the selected place with four screws or self-tapping screws (supplied). The mount is fixed on the platform, following which the mount can hold various accessories of the FASTen® series.



FFr444 Mount with enlarged platform

for installation on hard surface (aluminium, plastic or wooden) mounting platform fits the rectangular seats of the most kayak brands. Furthermore, it can be installed on the Scotty mounting platforms: 341 Glue-On Mount glued on an inflatable side and 449 Portable Clamp Mount in place of 241 Combination Side.

1.01.003.01.01
1.01.003.01.02

110*63*41 mm

222 g



FMs224 Mount and PVC mounting platform (110x110 mm)

with 3M VHB Scotch for quick installation on smooth and hard flat surfaces

1.01.004.01.01
1.01.004.01.02
1.01.004.01.03

110*110*44 mm

222 g



Wood
Plastic
Aluminium
Fiberglass

FMs225 Mount and enlarged PVC mounting platform

(140x140 mm) with 3M VHB Scotch for quick installation on smooth and hard flat surfaces

1.01.005.01.01
1.01.005.01.02
1.01.005.01.03

140*140*45

260 g

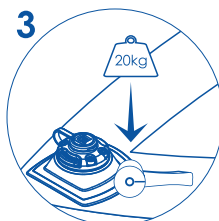
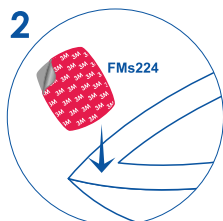
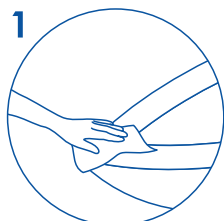



Mount with pad for installation on inflatable side

The mount kit allows for quick and easy installation of the whole range of FASTen® accessories on an inflatable side of a watercraft. This is a perfect assistant for inflatables and powerboats owners who appreciate the comfort and functionality of their watercraft.

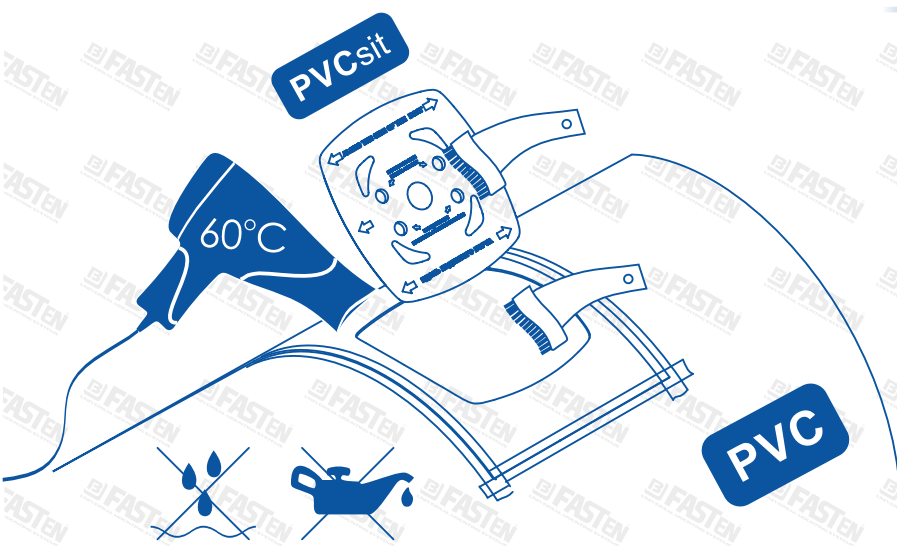
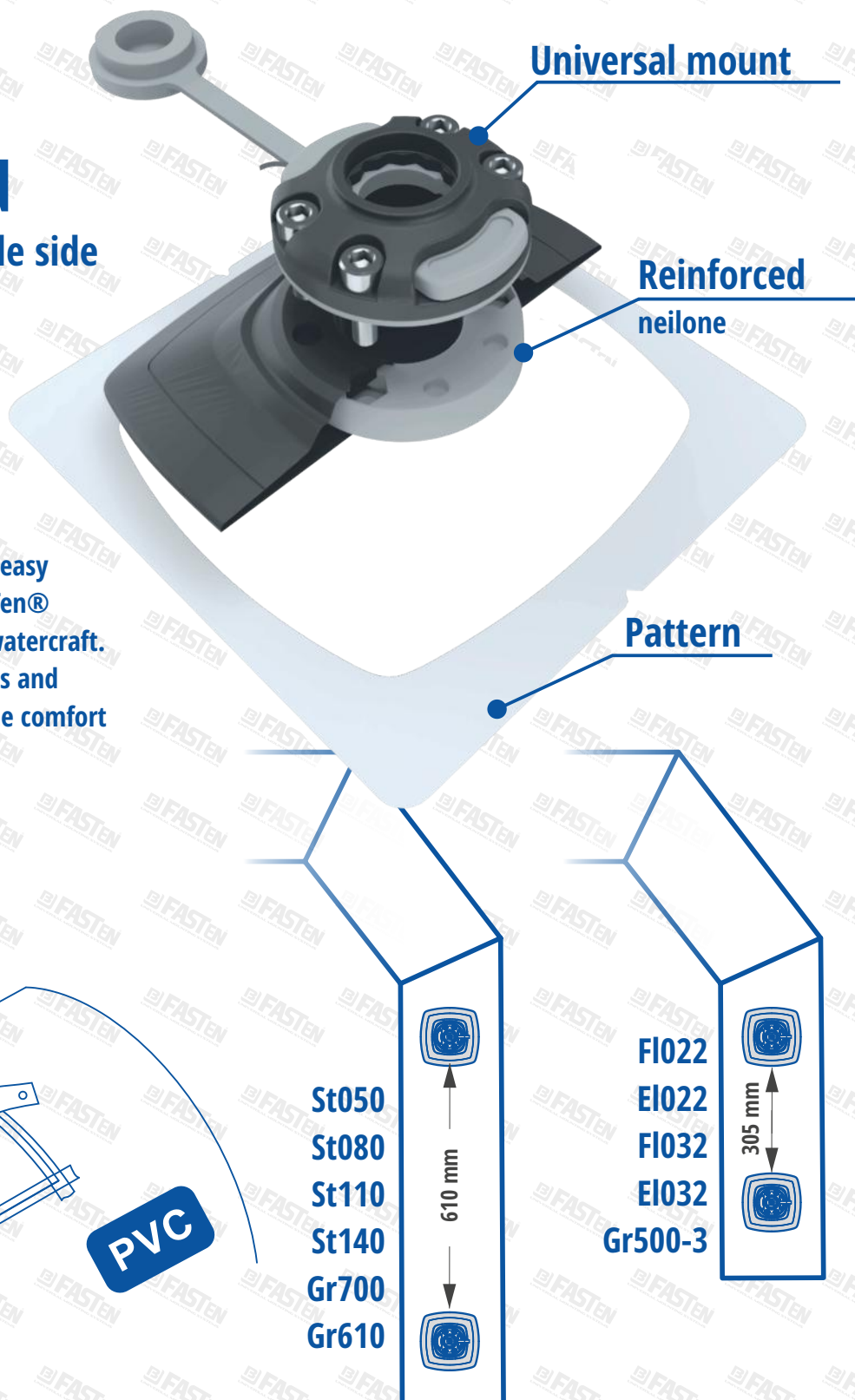



FMp224

Mount with pad (110x110 mm)

for installation on inflatable PVC cylinder

The mount kit allows for quick and easy installation of the whole range of FASTen® accessories on an inflatable side of a watercraft.

1.01.006.01.01

1.01.006.01.02

1.01.006.01.03

110*110*43

195



FMp225

Mount with enlarged pad (140x140 mm)

for installation on inflatable PVC cylinder

The enlarged glue-on surface allows the pad to withstand considerable loads. Recommended for installation oarlocks, anchor assembly, mooring bollard, etc.

1.01.007.01.01

1.01.007.01.02

1.01.007.01.03

140*140*44

268



FMp226

Mount with EPDM pad (110x110 mm)

for installation on HYPOLON inflatable cylinder of ORCA

1.01.016.01.01



FMp227

Mount with PU pad (110x110 mm)

for installation on PVC inflatable cylinder or on Nitrilon of GUMOTEX

1.01.017.01.01



INOX
STAINLESS
STEEL



Mount with platform for installation on tube

This mount kit is meant for self-installation of equipment and accessories on round rails or tubular railings (Ø 22, 25 mm) of yachts and powerboats and consists of the Fs219 mount and the Mr125 mounting platform.

Advantages:

- No drilling of the tube is required - it is fixed by crimping mechanism
- Easily rearranged from one tube to another for quick re-equipping of a watercraft
- Has locking screws that allow you to move the mount along the tube without detachment and, when tightened, prevent axial rotation of the mounting platform
- Allows you to remove and rearrange the mounted equipment without removing the mount with the platform.

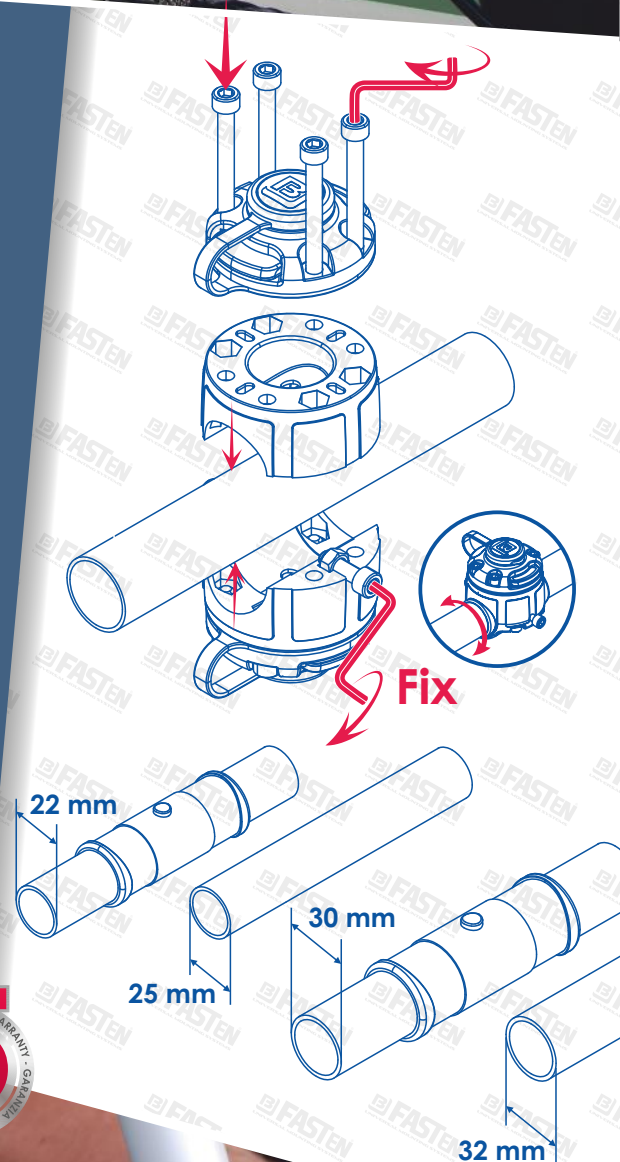

Kardinal



FMr125**Mount with platform**

for installation on Ø22/25 mm tube

The set consists of the Fs219 mount and Mr125 mounting pad. It allows you to fit the mount on a tube of Ø 25 mm or Ø 22 mm with the use of rubber spacer.

1.01.008.01.01

1.01.008.01.02

1.01.008.01.03

69*70*65 mm

247 g

**FMr132****Mount with platform**

for installation on Ø30/32 mm tube

The mount kit for a tube consisting of the Fs219 mount and the Mr132 mounting pad.

1.01.009.01.01

1.01.009.01.02

1.01.009.01.03

76*70*65 mm

248 g

**FMr225****Mounts (2 pcs) with platform**

for installation on Ø22/25 mm tube

The mount kit for a tube consisting of the two Fs219 mounts and the Mr225 mounting pad.

1.01.010.01.01

1.01.010.01.02

1.01.010.01.03

103*70*65 mm

354 g

**FMr232****Mounts (2 pcs) with platform**

for installation on Ø30/32 mm tube

The mount kit for a tube consisting of the two Fs219 mounts and the Mr232 mounting pad.

1.01.011.01.01

1.01.011.01.02

1.01.011.01.03

110*70*65 mm

355 g



Ondatra



Ondatra



Mount with platform for installation on C-shaped track

The set is designed for self-installation of equipment and accessories on a C-shaped track. It consists of the Fs219 versatile mount and the Ma mounting platform. Convenient for use in powerboats whose track faces the inner space of the watercraft. The mounting platform has two seats for the simultaneous accommodation of two mounts (one on each side of the platform) to save the usable space in a watercraft.

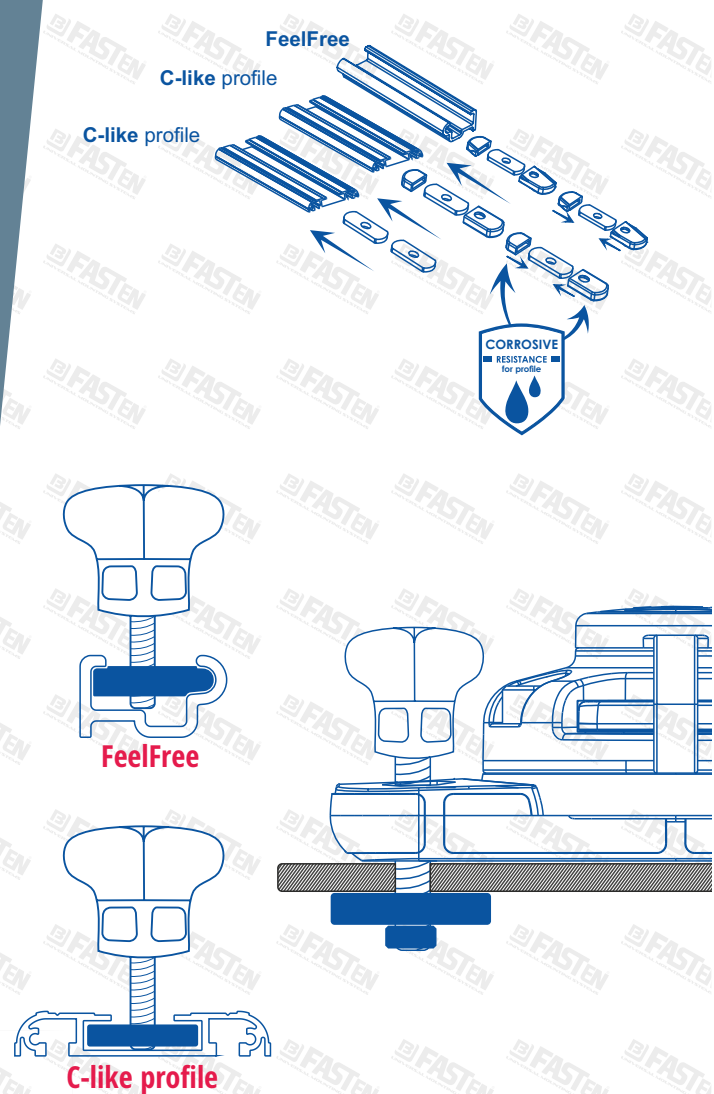



FMa

Mount with platform for vertical installation on C-shaped track (platform with additional option of installation of a second mount)

It is convenient for use in motor boats where the working surface of the C-shaped track faces the inner space of the watercraft.

1.01.013.01.01

1.01.013.01.02

1.01.013.01.03

142*65*58 mm

251 g



x2
Fs219



FFr222

Mount with enlarged platform for horizontal installation on C-shaped track

It is especially convenient for use in kayaks whose track does not face the inner space of the watercraft but upwards.

1.01.012.01.01

1.01.012.01.02

110*63*50 mm

240 g





FMc

1.01.014.01.01

1.01.014.01.02

128*76*83 mm

568 g

Mount with mounting clip for installation on shaped tubes of up to 70 mm in diameter (platform with additional option of installation of a second mount)

The mount and mounting clip make it possible to secure pieces of equipment on a tube, railing, handrails, mast or track without drilling. Thanks to the elastic inner coating, the clip can clamp items of round, square and rectangular cross-section. The set includes a coupling bolt and nut to keep the clip closed and control the compression force. The clip has a provision for two Fs219 mounts (one mount is included in the set, the other one can be ordered separately).

The mounting clip can be used with items from 20 to 60 mm in volume.

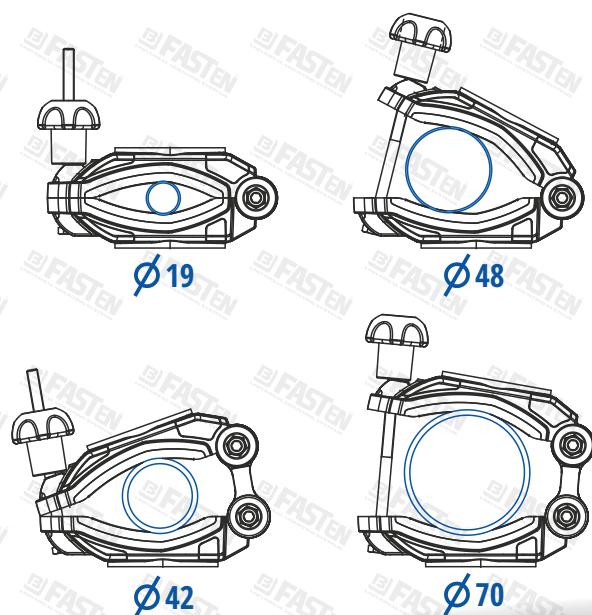

x2
Fs219

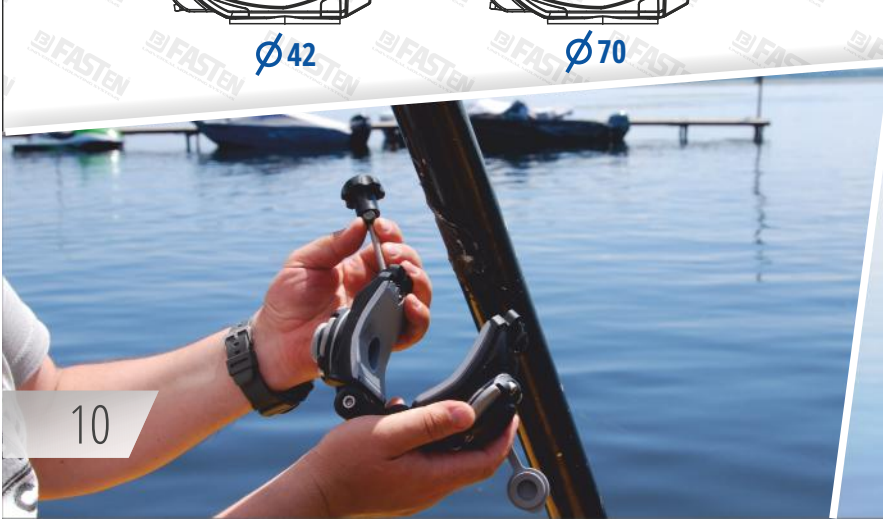



FMk

**Mount with mounting clamp for
installation on transom board or 40 mm side
(platform with additional option of installation of a second mount)**

1.01.015.01.01

1.01.015.01.02

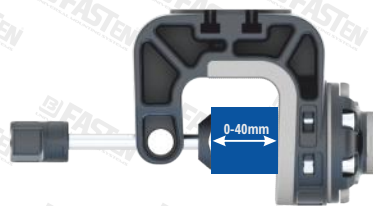

x2
Fs219

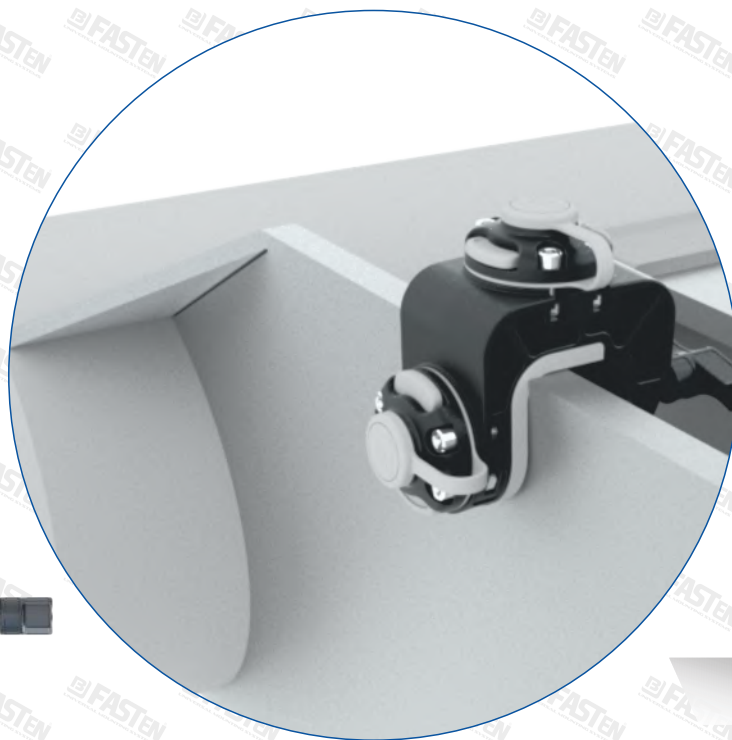
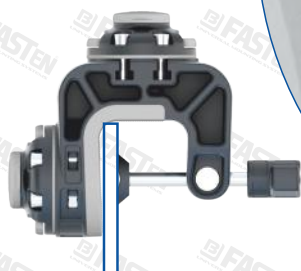
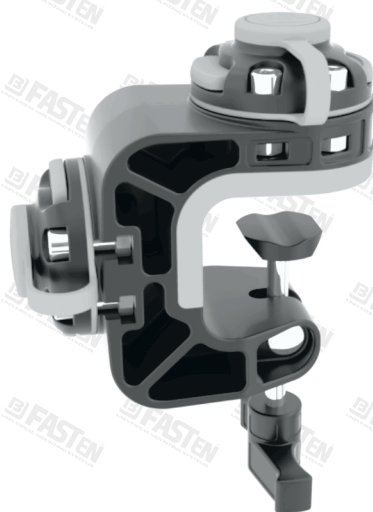



Round rail

This is designed to expand the operating space or install additional accessories. It offers exciting possibilities for expanding the operating space and can be used as a handhold. The rail is equipped with two universal mounts for installation of various types of equipment. Particularly useful for trolling.

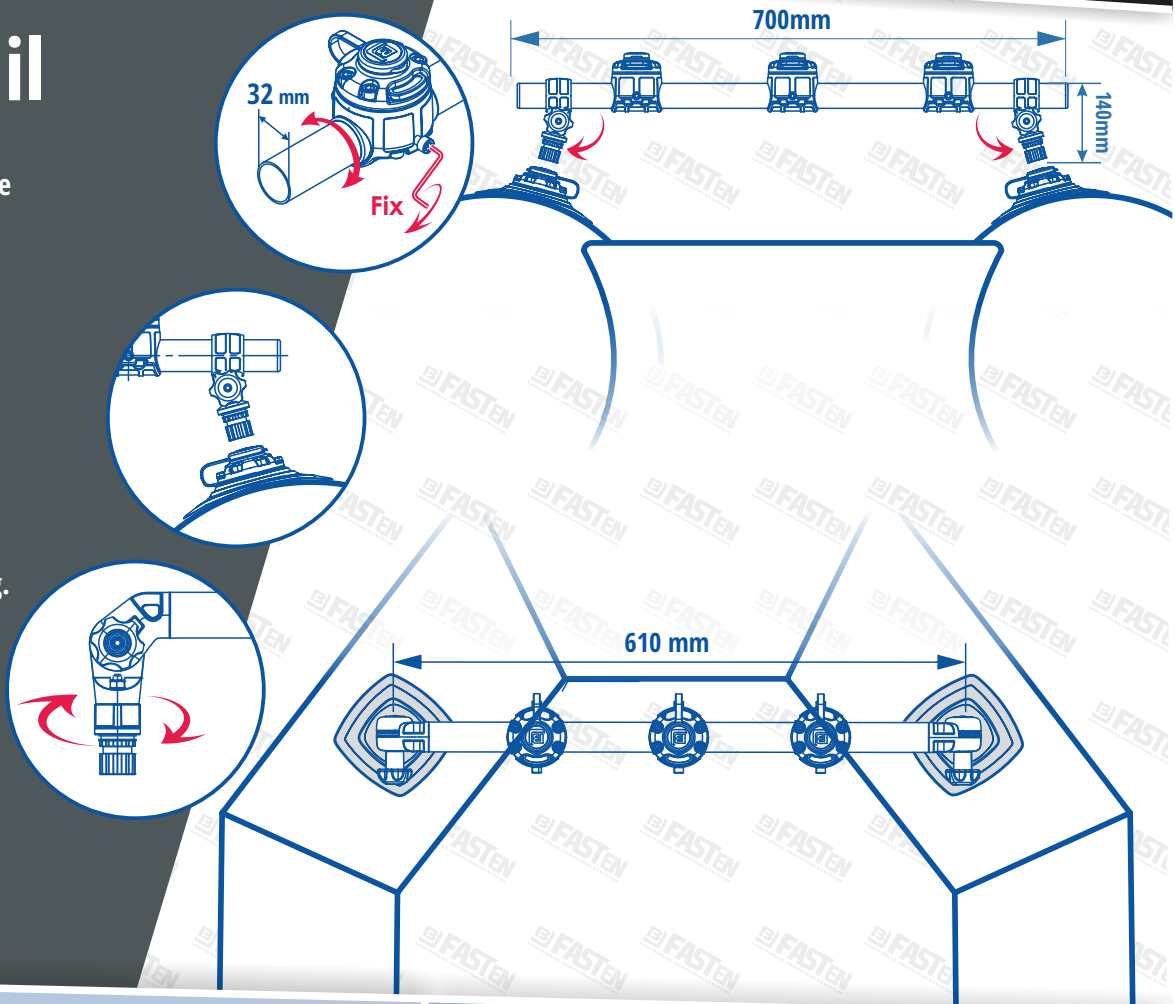

Gm350-3**Round rail with three Fmr132 mounts (350 mm, one fastening point)**

1.02.001.01.06

ALA

1.02.001.01.05

ALA

1.02.001.01.04

ALA

350*136*65 mm

945 g

**Gr500-3****Round rail with three Fmr132 mounts (500 mm, two fastening points)**

1.02.002.01.06

ALA

1.02.002.01.05

ALA

1.02.002.01.04

ALA

500*140*80 mm

1106 g



SUP «Fanatik»

Gr610-2**Round rail with two FMr132 mounts (610 mm, two fastening points)**

1.02.003.01.06

ALA

1.02.003.01.05

ALA

1.02.003.01.04

ALA

649*167*83 mm

1016 g

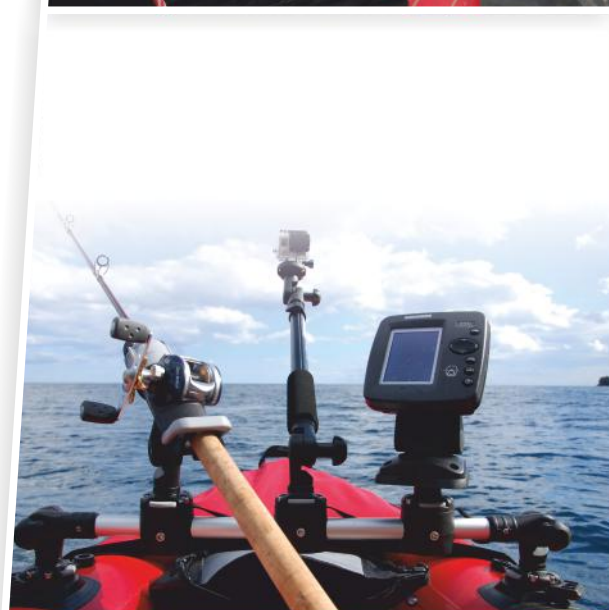
**Gr700-2****Round rail with two FMr132 mounts (700 mm, two fastening points)**

1.02.004.01.06

ALA

1.02.004.01.05

ALA

1.02.004.01.04

ALA

700*140*80 mm

998 g

**Ed120****Rotatable round rail extender (120 mm), 2 pcs, for Gr 500 and Gr 700 round rails**

1.02.005.01.04

ALA

1.02.005.01.05

ALA

1.02.005.01.06

ALA

286*74*55 mm

582 g

**Ex120****Tilting extender (120 mm), 2 pcs, for Gr 610 round rail**

1.02.006.01.04

ALA

1.02.006.01.05

ALA

1.02.006.01.06

ALA

230*72*59 mm

364 g





Sc800

Support stand

with two FMr132 mounts
(800x500 mm, three fastening points)

1.02.007.01.05

ALA

1.02.007.01.06

ALP

931*641*639 mm

2460 g

This is used to attach various equipment. It can also be used as a handrail, awning holder, etc.

It is a support frame of aluminium tubing and polyamide swivel and tilt parts mounted on tube joints. It is fitted in four mounts owing to which it stands very firmly. The tube has two mounts that allow for a quick installation of various equipment. It is convenient to use as a support for balance in canoes and kayaks or a round rail in inflatable boats.



St050

Support stand with two

FMr132 mounts
(800x500 mm, four fastening points)

1.02.008.01.06

ALP

1.02.008.01.04

ALA

943*871*385 mm

2704 g

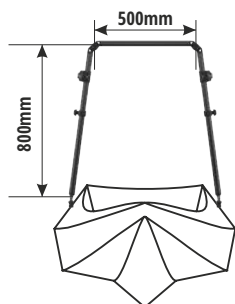

Kayak

St080

Support stand with two FMr132 mounts

(800x800 mm, four fastening points)

1.02.008.02.06

ALP

1.02.008.02.04

ALA

1171*945*385 mm

2820 g

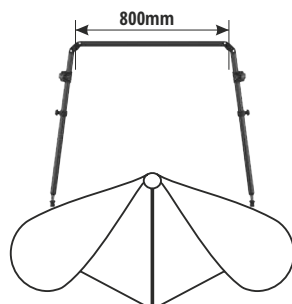

Kanoe

St110

Support stand with two FMr132 mounts

(800x1100 mm, four fastening points)

1.02.008.03.06

ALP

1.02.008.03.04

ALA

1471*945*385 mm

2934 g

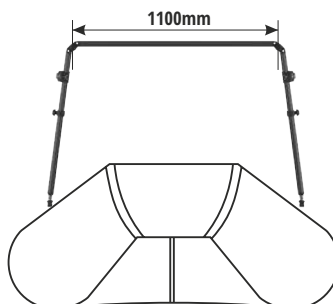

Boat

St140

Support stand with two FMr132 mounts

(800x1400 mm, four fastening points)

1.02.008.04.06

ALP

1.02.008.04.04

ALA

1771*945*385 mm

3049 g

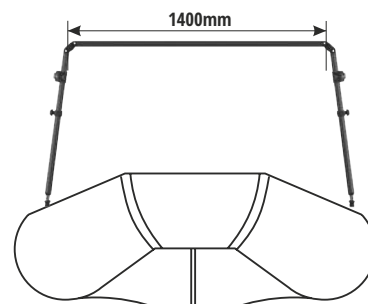

RIB

FMr



3D

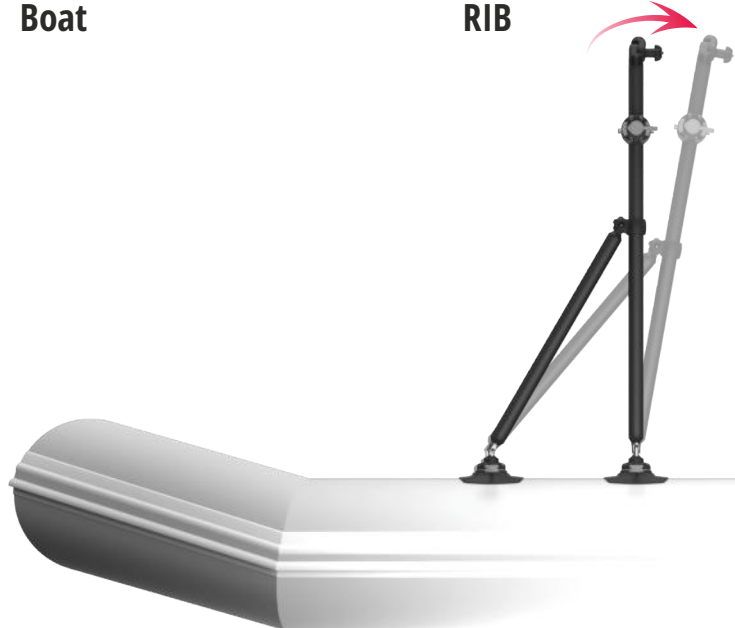

BORIKA

event partner





Ht213

Rod holder

1.03.001.01.01
1.03.001.01.02
1.03.001.01.03

This reliably secures a rod on the side of a watercraft. It provides full control over the process of fishing, has many adjustments and gives your watercraft a stylish look. Made of high strength plastic material withstanding heavy loads.

242*176*81 mm
330 g

Advantages of the holder:

- Equipped with a back stop that prevents rotation of the rod
- Can be installed in any position about its axis
- Has a locking ring to secure the rod reel, which prevents the loss of a fishing rod during trolling
- Allows you to adjust the inclination of the rod relative to the horizon.



HTb213

Rod holder with mount kit for hard side (Ht213+FMb)

1.03.001.02.01
1.03.001.02.02

242*183*86 mm
451 g



HTf213

Rod holder with with mount kit for C-shaped track (Ht213+FFr222)

1.03.001.03.01
1.03.001.03.02

242*182*126 mm
525 g



HTp213

Rod holder with mount kit for inflatable PVC cylinder (Ht213+FMp224)

1.03.001.04.01
1.03.001.04.02

242*186*140 mm
541 g



HTr213

Rod holder with mount kit for Ø22/25 mm tube (Ht213+FMr125)

1.03.001.05.01
1.03.001.05.02

242*210*87 mm
480 g

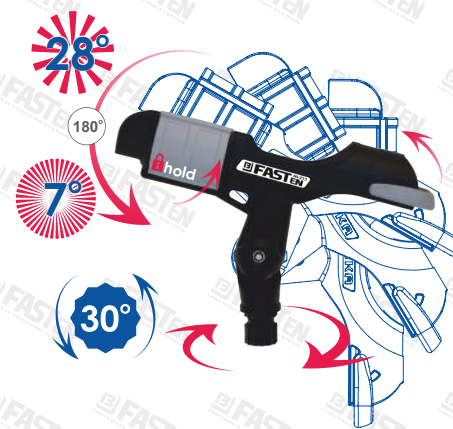

Fc229

Mooring cleat

This is used as a mooring device in watercrafts. It can also be used as a ring to run a rope down through the orifice. It is fitted in the universal mount, which ensures easy attachment and detachment.

1.13.001.01.01

1.13.001.01.02

1.13.001.01.03

139*68*32 mm

51 g



Hm273

Hook

The hook fitted in a mount can be used as a fastening device for additional equipment with the help of a halyard or rubber tightening device, net, etc. The hook comes as a one-piece item and is fitted in the FASTen® mount.

1.13.002.01.01

1.13.002.01.02

1.13.002.01.03

77*50*34 mm

22 g



Hm273-2

Hook, 2 pcs

1.13.002.02.01

1.13.002.02.02

1.13.002.02.03



Rm273

Elliptical ring

This ring fitted in a mount can be used as a fastening device to attach additional equipment with the help of a halyard or rubber tightening device or rubber net with end hooks. The ring comes as a one-piece item and is fitted in the FASTen® mount.

1.13.003.01.01

1.13.003.01.02

1.13.003.01.03

65*56*34 mm

36 g



Rm273-2

Elliptical ring, 2 pcs

1.13.002.02.01

1.13.002.02.02

1.13.002.02.03



Oh032

Retainer for tube

(of up to Ø32 mm) or oars

This is used to retain a Ø32 mm tube. It can also be used for retaining an oar during storage or transportation. It is fitted in a mount. If used in combination with the RI032 oarlock, it allows for using the oar as a side round rail that accommodates accessories and equipment.

1.13.005.01.01

1.13.005.01.02

106*43*38 mm

34 g



Oh032-2

Retainer for tube

(of up to Ø32 mm) or oars, Set of 2pcs

1.13.005.02.01

1.13.005.02.02



Cf221

Rigging clip

composed of adapter and stainless steel clamp with lock

1.13.007.01.01

1.13.007.01.02

77*32*32 mm

40g



Cf221-2

Rigging clip set (2 pcs)

composed of adapter and stainless steel clamp with lock

1.13.007.02.01

1.13.007.02.02

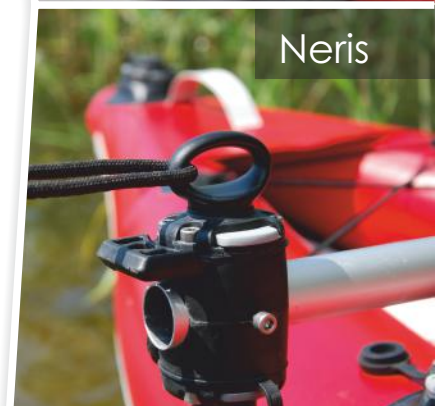

Tp014

1.05.008.01.01

1.05.008.01.02

154*64*39 mm

205 g

Photo-video equipment mount with 1/4" thread and tilt and swivel mechanism

This is used to mount photo and video equipment. The mount has 1/4" thread that allows for attaching it to photo and video equipment whose footing has the same thread. It allows for adjustments of the tilt angle of a mounted device and of its position around its axis.

1/4"



Tp038

1.05.008.02.01

1.05.008.02.02

154*64*39 mm

195 g

Photo-video equipment mount with 3/8" thread and tilt and swivel mechanism



3/8"

Ng001

1.05.001.01.01

1.05.001.01.02

212*126*69 mm

64 g

Holder

with two mounts for action cameras or portable navigation lights

It secures a camera or Navisafe portable navigation lights in the Fasten universal mount. The advantage of the adapter is that it allows multiple accessories to be alternately fitted in the same mount. For example, in the daytime one can perform camera shooting while in the dark navigation lights can be fitted. Thus, the ease of use combines with saving valuable space onboard.

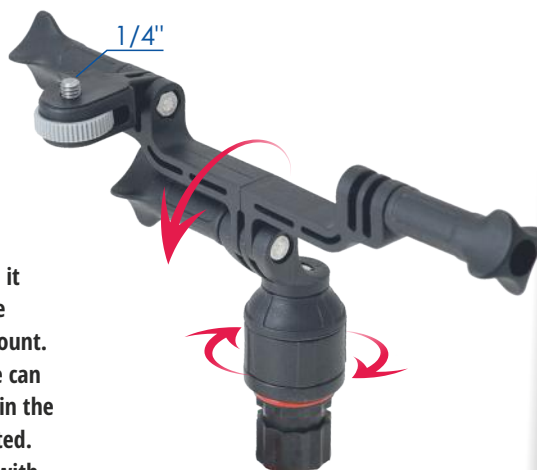

Ng002

1.05.002.01.01

1.05.002.01.02

212*126*70 mm

142 g

Swivel and tilt holder for action camera or portable navigation lights

The advantages include: orifices for a spring hook or camera safety cord. The swivel and tilt mechanism makes it possible to adjust the installed accessory in different planes.



120°



Ø10-25mm

NEW Ng004

1.05.004.01.01

1.05.004.01.02

Mount for two action cameras or portable navigation lights

1/4"





Ng400

Action camera holder with Ex400 extender with tilt and swivel capability

1.05.005.01.06
/ALP



400 mm

Ng600

Telescopic two-stage holder for action camera (600 mm) with tilt and swivel capability

1.05.006.01.06
/ALP



600 mm

Ng1100

Telescopic three-stage holder for action camera (1100 mm) with tilt and swivel capability

1.05.007.01.06
/ALP



1100 mm

280 mm

For flag

Ng1100

Lg400

Telescopic supports (400 mm) for action camera holder with tilt and swivel capability

1.05.009.01.06
/ALP

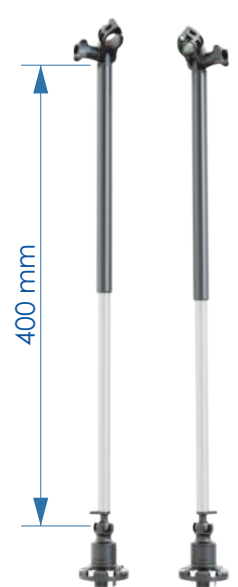

400 mm



Unlock

Lock

Lg400





It is used to secure the case in a convenient location onboard and protect the device from moisture. It is fitted in the Fs219 mount. It allows you to reliably secure a smart phone and use it while on the move for navigation, photo and video shooting, etc. The holder is equipped with swivel-tilt mechanism for easy adjustment of the device and locking in the selected position.

MAx030

1.06.001.03.01

Universal poly-urethane waterproof case (Model AG-W1) for smart phones of up to 5.7" with tilt and swivel holder, Model Max020



TAX150

1.06.003.03.01

Universal poly-urethane waterproof case (Model AG-W3) for smart phones and tablets of up to 8.4" with tilt and swivel holder Tax140



TAX160

1.06.003.04.01

Universal poly-urethane Waterproof Case (Model AG-W4) for tablets of up to 10.5" with tilt and swivel holder Tax140



TAX141

1.06.001.02.01

Max020 holder with tilt and swivel mechanism complete with gadget mount on 3M VHB scotch tape (Model UA-2) for Type-T adapter



Ua1

1.06.010.01.01

Universal mount for gadgets on 3M VHB scotch tape to be mounted on MAX020 holder with Type-M adapter



MAx021

1.06.001.02.01

Max020 holder with tilt and swivel mechanism complete with gadget mount on 3M VHB scotch tape (Model UA-1) for Type-M adapter



Ua2

1.06.011.01.01

Universal mount for gadgets on 3M VHB scotch tape to be mounted on TAX040, TAX140 and TAX140-1 holder with Type-M adapter



stick



TAx140

Holder with tilt and swivel mechanism and Type-T adapter for ARMOR-X waterproof cases for AG-W3, W4 and MX models and universal mount of UA-2 model

1.06.003.01.01

1.06.003.01.02

177*91*56 mm

121 g



MAx020

Holder with tilt and swivel mechanism and Type-M adapter for ARMOR-X waterproof cases for AG-W1 models and universal mount of UA-1 model

1.06.001.01.01

1.06.001.01.02

149*78*53 mm

110 g



Ag-W1

Universal poly-urethane waterproof case for smart phones of up to 5.7" to be mounted on MAx020 model holder

1.06.005.01.01

108*180*10 mm

80 g



Ag-W3

Universal poly-urethane waterproof case for smart phones and tablets of up to 8.4" to be mounted on TAx040 and TAx140-1 holder

1.06.006.01.01

160*239*10 mm

100 g



Ag-W4

Universal poly-urethane waterproof case for tablets of up to 10.5" to be mounted on TAx040 and TAx140-1 holder

1.06.007.01.01

210*274*10 mm

120 g



MX-U3X-BK

Waterproof Protective Case for tablets of up to 8" to be mounted on TAx040, TAx140 and TAx140-1 holder

1.06.008.01.01

220*180*10 mm



MX-U4X-BK

Waterproof Protective Case for tablets of up to 10" to be mounted on TAx140 and TAx140-1 holder

1.06.009.01.01

255*200*10 mm

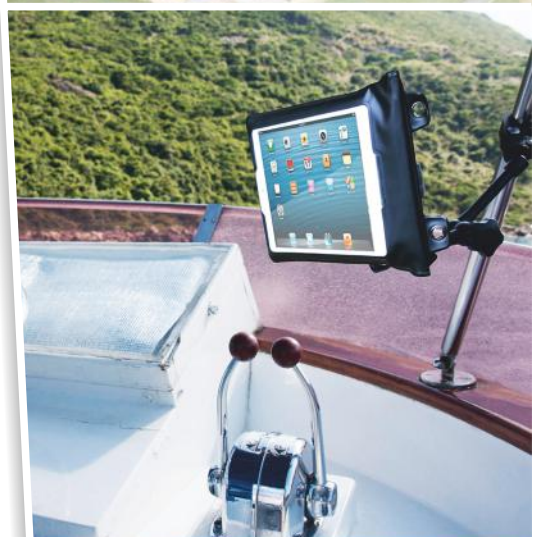

Holder for LONAKO portable navigation lights

It is designed to easily secure LONAKO portable navigation lights in the Fasten universal mount. If necessary, the lights are easy to dismount in one motion.

Lf001 Holder for LONAKO portable navigation lights

1.08.003.01.01

107*36*32 mm

70 g

Lf002 Reinforced swivel and tilt holder for LONAKO portable navigation lights, can be used with extenders of EX225,325, 610 and 632 models

1.08.004.01.01

177*54*39 mm

155 g

Lf003 Swivel and tilt holder for LONAKO portable navigation lights, can be used with extender of Exx400 model

1.08.005.01.01

Lc003 LONAKO portable waterproof navigation light emitting light: green (right side), red (left side), white (stern). Equipped with a remote control unit and self-powered from sun and wind.

1.08.007.01.01



Lw001 LONAKO portable waterproof all-round navigation light emitting white light. Equipped with a remote control unit and self-powered from sun and wind.

1.08.008.01.01



Lf1100 Telescopic holder for LONAKO portable navigation lights (1100 mm)

1.08.006.01.04

ALA



Nw001 NaviSafe portable waterproof all-round light emitting white light. Powered from batteries

1.08.002.01.01

Nc003 NaviSafe portable waterproof sidelight emitting light: green (right side), red (left side), white (stern). Powered from batteries

1.08.001.01.01





Headlight mount

Torch mount

NEW Hf030

Torch mount (up to 30 mm in diameter) with tilt and swivel capability around axis

1.05.010.01.01



NEW Lh130

Holder with tilt and swivel mechanism and elastic cap lock for securing items (of up to 30 mm in diameter)

1.08.010.01.01



NEW Lh030

Holder with elastic cap lock for securing items (of up to 30 mm in diameter)

1.08.009.01.01



NEW Hf001

Headlight mount with leg in form of clamp not exceeding 30 mm in width

1.08.011.01.01



NEW Hf002

Mount for "LEDwise pro" headlight of 1700 - At609model

1.08.012.01.01

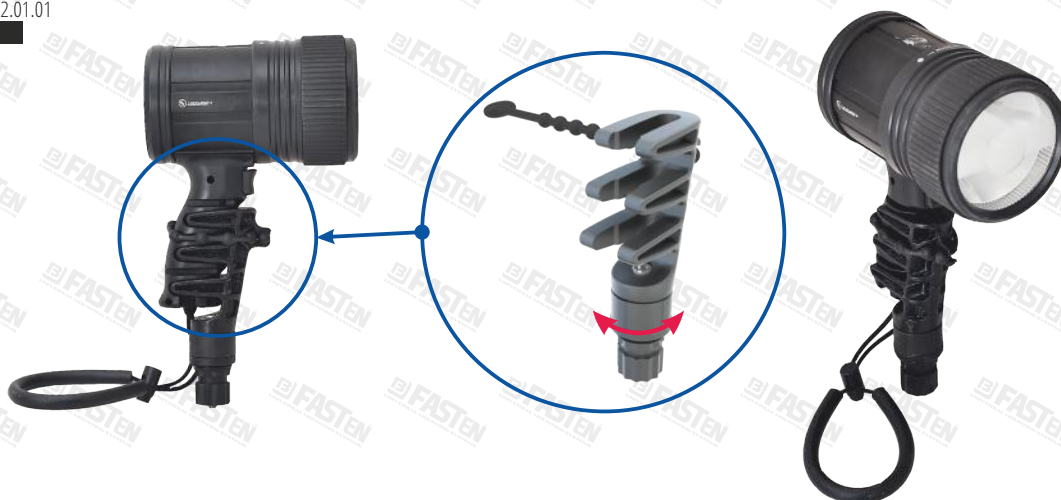

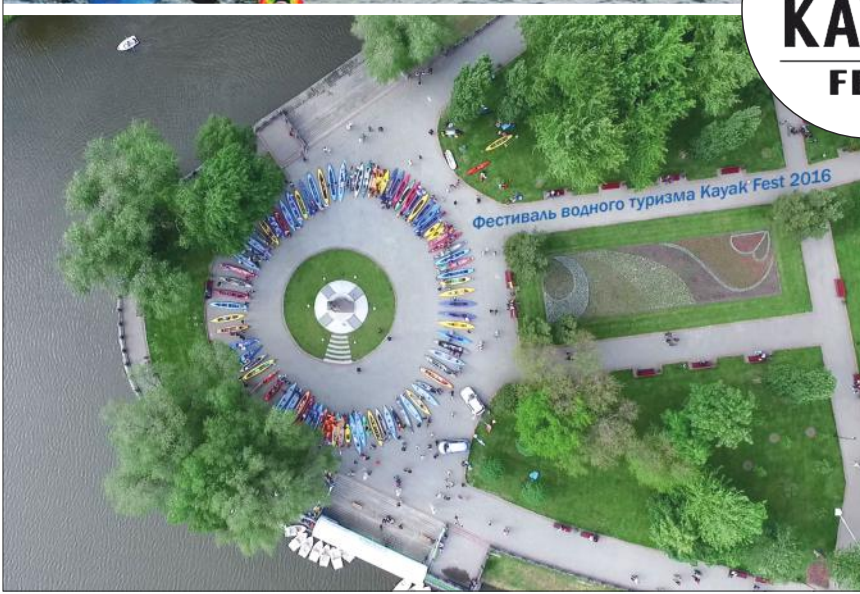

Tp173

TOPEAK waterproof case holder for smartphones with tilt and swivel mechanism

1.09.001.01.01

133*79*53 mm

113 g

It quickly secures TOPEAK cases for smartphones and tablets in the mount. It is fitted in the Fs219 mount. It has a hole for the safety cord.

For the convenient use of a smartphone a provision is made for tilting and rotating the holder (in the axis of the mount and that of an accessory). The design allows you to adjust the viewing angle and secure the holder in the selected position.

This enables keeping your smartphone or GPS-navigator within immediate sight. The case protects the device from moisture, dust and mechanical damage while keeping the touch-screen unobstructed.

Caution! Do not leave the device in the case for a long time when it is exposed to direct sunlight or heat sources.

**Tp274**

TOPEAK PVC smart phone waterproof case 5"

1.09.003.01.01

142*77*31 mm

63 g

**Tp275**

TOPEAK PVC smart phone waterproof case 6"

1.09.004.01.01

173*94*32 mm

75 g

**Tp284**

TOPEAK smart phone waterproof case 5" with tilt and swivel holder of Tp173 model

1.09.001.02.01

**Tp285**

TOPEAK smart phone waterproof case 6" with tilt and swivel holder of Tp173 model

1.09.001.03.01



+ INSTALLATION
KIT Tp173

+ INSTALLATION
KIT Tp173





Platform for fishfinder and optional equipment

This is used to mount fishfinders of popular brands (Humminbird, Garmin, Lowrance, Raymarine and others) as well as mounting photo/video equipment, GoPro cameras,, video recorders and other equipment.

The platform is designed to fit the mounting holes of most types of equipment whose size fits that of the platform. To install equipment on the platform, standard fasteners are used. It is quickly installed and reliably secured in the universal Fs219 mount.

LOWRANCE
Elite-7 Ti
Elite-5 Ti
Elite-4
MARK-4
Elite-5 CHIRP
HOOK-5
HOOK-4
HOOK-5 CHIRP Gold

RAYMARINE
Dragonfly 6&7

GARMIN
Striker 4
42-55 Series
GPSMAP 527
GPSMAP 547

HUMMINBIRD
500 Series
600 Series

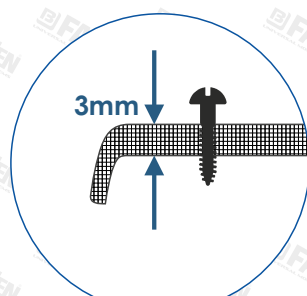
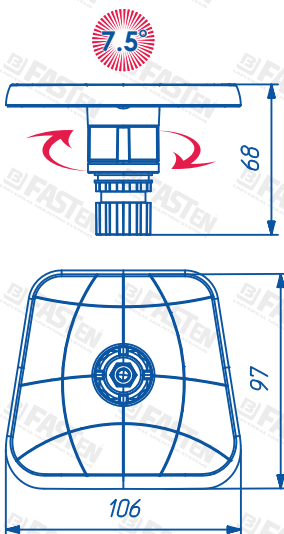

Garmin
Striker 4
42-55 Series
GPSMAP 840xs
GPSMAP 1020xs
GPSMAP 1040xs
GPSMAP 7610
GPSMAP 7612
GPSMAP 7607
GPSMAP 7608
GPSMAP 7410
Striker 5&7 Series
72-95 Series

Raymarine
eS Series

HUMMINBIRD
800 Series
900 Series
1100 Series

LOWRANCE
HOOK-7
Elite-7 CHIRP

HDS-7 Gen2 Touch
HDS-7 Gen3
Elite-9 CHIRP
HDS-9 Gen2 Touch
HDS-9 Gen3
HDS-12 Gen2 Touch
HDS-12 Gen3

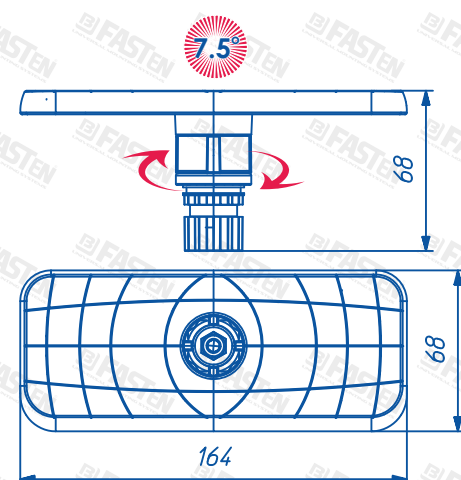

Ss223**Platform (164x68 mm)**

for fishfinder and optional equipment
with swiveling mechanism

1.04.003.01.01

1.04.003.01.02

164*68*68 mm

143 g

**Ssb223****Platform (164x68 mm)**

for fishfinder and optional equipment
with mount kit for hard side
(Ss223+FMb)

1.04.003.02.01

1.04.003.02.02

164*74*68 mm

390 g

**SSt223****Platform (164*68 mm)**

with swivel and tilt mechanism
for fishfinder and optional equipment

1.04.004.01.01

1.04.004.01.02

164*138*68 mm

238 g

**SSf223****Platform (100x100 mm)**

for fishfinder and
optional equipment with mount kit
for C-shaped track (SLt223+FFr222)

1.04.003.03.01

1.04.003.03.02

164*74*68 mm

485 g

**SSx223****Platform (164x68 mm)**

with swivel and tilt mechanism
and extender for fishfinder
and optional equipment
(SSt223+Ex325)

1.04.004.02.01

1.04.004.02.02

443*164*68 mm

585 g

**SL223****Platform (100x100 mm)**

for fishfinder and optional
equipment with swiveling mechanism

1.04.001.01.01

1.04.001.01.02

106*97*68 mm

125 g

**SLf223****Platform (100x100 mm)**

for fishfinder and optional equipment
with mount kit for C-shaped track
(SLt223+FFr222)

1.04.001.02.01

1.04.001.02.02

126*99*74 mm

455 g

**SLp223****Platform (100x100 mm)**

for fishfinder and optional equipment with mounting
kit for inflatable PVC cylinder (SL223+FMp224)

1.04.001.03.01

1.04.001.03.02

110*110*76 mm

315 g

**SLt223****Platform (100*100 mm)**

with swivel-tilt mechanism
for fishfinder and optional equipment

1.04.002.01.01

1.04.002.01.02

138*106*97 mm

208 g

**MIa****Swivelling mounting platform**

(Ø 60 mm) for equipment

1.04.010.01.01

1.04.010.01.02

62*62*14 mm

118 g

**TAb218****Swivel and tilt joint**

with mounting platform and
mount kit for hard side

1.04.011.02.01

1.04.011.02.02

145*79*63 mm

330 g

**TAm218****Swivel and tilt**

mounting platform
(Ø 60 mm) for
equipment

1.04.011.01.01

1.04.011.01.02

138*66*62 mm

169 g



Fishfinder transducer arm mount

This allows for installation of a fishfinder transducer on a transom. It is fitted in the mount. The mechanism enables the arm to be adjusted for stiffness. With a watercraft on the move, in case of a collision with an obstacle the arm moves sideways, which helps to protect the transducer from damage.



Ft450

Fishfinder platform (100x100 mm) with telescopic transducer holder with provision for installation of various transducers

1.04.007.01.04

ALA



Ft600

Fishfinder top plate (100 x 100 mm) with transducer arm mount

1.04.009.01.04

ALA

501*310*152 mm

547 g



FTp600

Fishfinder top plate (100 x 100 mm) with transducer arm mount and mount kit for installation on inflatable side (Ft600+FMp224)

1.04.009.02.04

ALA



+ INSTALLATION
KIT F m b



Ft500

Telescopic fishfinder transducer holder with provision for installation of various transducers

1.04.008.01.04
ALA

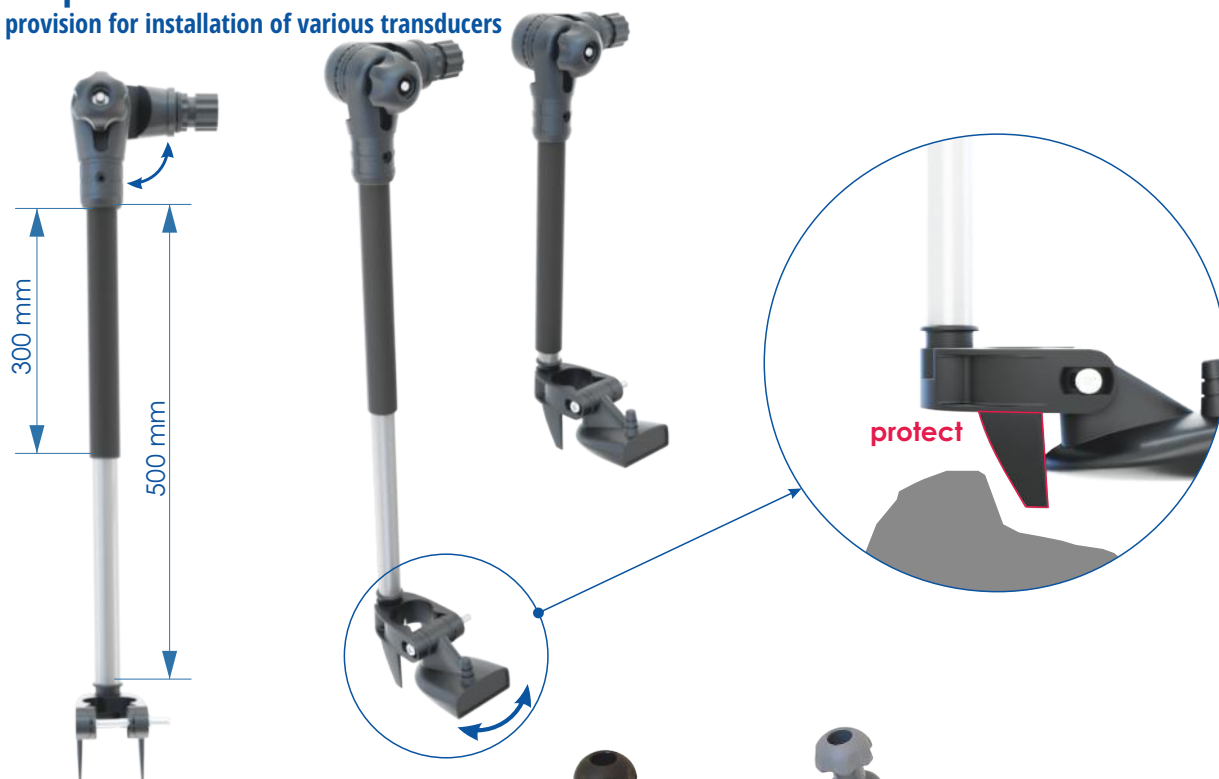

Ft300

Fishfinder transducer arm mount (300mm)

1.04.005.01.04
ALA
1.04.005.01.05
ALA
1.04.005.01.06
ALP

This allows for installation of a fishfinder transducer on a transom. It is fitted in the mount. The mechanism enables the arm to be adjusted for stiffness. With a watercraft on the move, in case of a collision with an obstacle the arm moves sideways, which helps to protect the transducer from damage.

396*64*39 mm
250 g



STm300

Mount kit for fishfinder transducer installation on transom board (Ft300+FMb)

1.04.005.02.04
ALA
1.04.005.02.06
ALP

403*80*64 mm
407 g



Anchor lock

This is fitted in the FASTen mount and ensures easy dropping and raising of an anchor. It is suitable for up to 35 mm wide straps and Ø10 mm ropes. The locking mechanism holds the anchor in a raised position without the need for securing a strap/rope additionally.

Ø 1-10mm



AI002

Anchor lock for anchors of up to 8 kg

1.10.001.01.01

1.10.001.01.02

99*61*52 mm

176 g



AI003

Anchor lock with tilt gear for anchors of up to 8 kg

1.10.002.01.01

1.10.002.01.02

182*81*52 mm

268 g

The tilt gear allows for adjustment
of the anchor lock depending on
the watercraft position.



ALp002

Anchor lock for anchors of up to 8 kg with mount kit for inflatable side (AI002+FMp224)

1.10.001.02.01

1.10.001.02.02

110*110*108 mm

395 g



INSTALLATION
KIT FFr444



Alf003

Anchor lock with tilt gear for anchors of up to 8 kg and mount kit for C-shaped track (AI003+FFr222)

1.10.002.03.01

1.10.002.03.02

188*126*63 mm

490 g



INSTALLATION
KIT FFr444



ALb003

Anchor lock with tilt gear for anchors of up to 8 kg and mount kit for hard side (AI003+FMb)

1.10.002.02.01

1.10.002.02.02

188*79*63 mm

423 g



INSTALLATION
KIT FFr444



Anchor roller

This is fitted in the universal FASTen® mount and ensures easy dropping and raising of an anchor. It is suitable for Ø10 mm ropes and equipped with a loop guide for a rope.

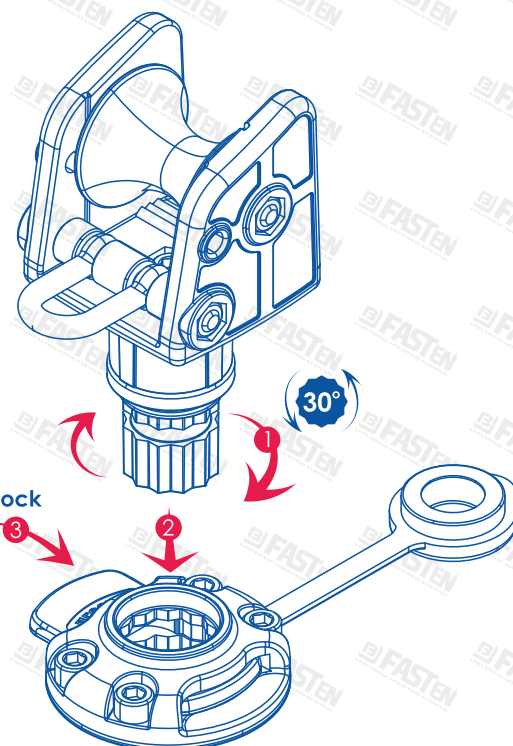



Ar002 Anchor roller

1.10.003.01.01

1.10.003.01.02

99*61*52 mm

169 g



ARp002 Anchor roller with mount kit for inflatable side (Ar002+FMp224)

1.10.003.02.01

1.10.003.02.02

110*110*108 mm

350 g



AR003 Anchor roller with tilt mechanism

1.10.004.01.01

1.10.004.01.02

182*81*52 mm

269 g

for anchors of up to 8 kg

The tilt gear allows for adjustment of the anchor roller depending on a watercraft position.



ARb003 Anchor roller with tilt gear and a mount kit for hard side (Ar003+FMb)

1.10.004.02.01

1.10.004.02.02

188*79*63 mm

421 g

INSTALLATION KIT FMb





Extender

This allows for changing the positions of mounted equipment regardless of the mount position. It is convenient for mounting photo/video cameras and other electronic devices.

Et225

Aluminium tube extender (205 mm long and 25 mm in diameter)
with mounts turned towards each other at angle of 90°

1.14.002.01.06 / ALP
1.14.002.01.05 ALA
1.14.002.01.04 ALA

244*67*39 mm
155 g



Ex610

Aluminium folding tube extender (610 mm long and 32 mm in diameter) with joint in the middle

1.14.005.01.06 / ALP
1.14.005.01.05 ALA
1.14.005.01.04 ALA

649*63*39 mm
312 g



Ex610

Aluminium folding tube extender (610 mm long and 32 mm in diameter) with joint in the middle

1.14.004.01.06 / ALP
1.14.004.01.05 ALA
1.14.004.01.04 ALA

649*72*59 mm
440 g



Ex225

Aluminium tube extender (205 mm long and 25 mm in diameter)

1.14.001.01.06 / ALP
1.14.001.01.05 ALA
1.14.001.01.04 ALA

244*63*39 mm
150 g



Ex325

Aluminium tube extender (305 mm long and 25 mm in diameter)

1.14.003.01.06 / ALP
1.14.003.01.05 ALA
1.14.003.01.04 ALA

344*63*39 mm
180 g



Ex400

Aluminium tube extender (400 mm long and 22 mm in diameter)

1.14.006.01.06 / ALP



Tp173
Ng002
TAx140
MAx020
Lf003
Lh003

Tm450 Modular table

1.07.007.01.04

ALA

1.07.007.01.05

ALA

435*350*106 mm

2120 g



The table consists of two equal-sized parts (left and right) held together by screws. For maximum convenience, the table is equipped with bumpers and recesses for holding fishing gear and other tools. The table comes with telescopic legs of 300 mm in length. The table is fitted in two Fasten universal mounts. Additionally, on the table surface a provision is made for two mounts for securing various equipment of the FASTen series.

Tm305 Modular table extension

1.07.006.01.04

ALA

1.07.006.01.05

ALA

350*328*77 mm

1260 g

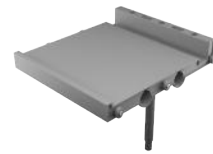

This is a bigger table consisting of three sections. The middle section is equipped with a drain hole. The table comes with telescopic legs of 800 mm in length. The seats for mounts on the lower surface of the table are designed in such a way that the table can be installed along or across the side or the corner between the side and the stern. Additionally, on the table surface a provision is made for two mounts for securing various equipment of the FASTen series.

Tm755 Modular table (755 mm) with telescopic legs (800 mm)

1.07.008.01.04

ALA

1.07.008.01.05

ALA

1268*674*811 mm

4260 g

This is a bigger table consisting of three sections. The middle section is equipped with a drain hole. The table comes with telescopic legs of 800 mm in length. The seats for mounts on the lower surface of the table are designed in such a way that the table can be installed along or across the side or the corner between the side and the stern. Additionally, on the table surface a provision is made for two mounts for securing various equipment of the FASTen series.



Tm800 Telescopic legs for modular table (800 mm)

1.07.010.01.04

ALA

1.07.010.01.05

ALA

830*42*42 mm

920 g

These elongate legs are for the Tm 755 modular table (with the middle section). The legs come with the table and are available to order as an option. The legs allow for working at the table while a person is standing

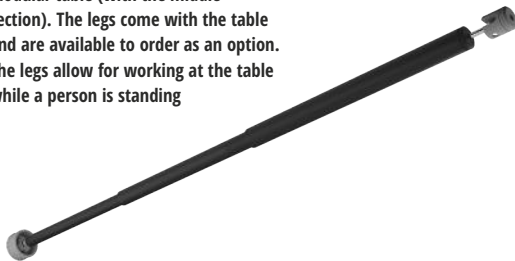

Tm300 Telescopic legs for modular table (300 mm)

1.07.009.01.04

ALA

1.07.009.01.05

ALA

310*42*42 mm

630 g



The legs are supplied complete with a table and are available to order as an option for both the standard table and the table with the extension. The length of the legs for the standard table is 300 mm.

Ch221 Folding stainless steel cup (3 pcs of 60 mL, 3 pcs of 150 mL) holder for 6 cups, unfolding fanwise with swivel adapter

1.07.002.01.01

ALA

1.07.002.01.02

ALA

235*235*93 mm

176 g



Ch321 Folding stainless steel cup (3 pcs of 60 mL, 3 pcs of 500 mL) holder for 6 cups, unfolding fanwise with tilt and swivel adapter

1.07.003.01.01

ALA

1.07.003.01.02

ALA

226*226*179 mm

295 g



Gl221 Set of stainless steel cups (3 pcs of 60 mL, 3 pcs of 150 mL)

1.07.004.01.08

SST

80*60*60 mm

201 g





BORIKA
since  1999

Folding aluminum tube ladder

This ladder is fitted in two mounts spaced at 305 mm. The design has swivel joints that enable the ladder to follow the shape of an inflatable side and to fold it for storage or transportation.

Caution!!! To avoid tipping the boat, it is recommended to mount the ladder at stern or bow. If both the ladder and an engine/motor are mounted at stern, make sure that there is an adequate counterweight at bow.

MAX WEIGHT 130kg

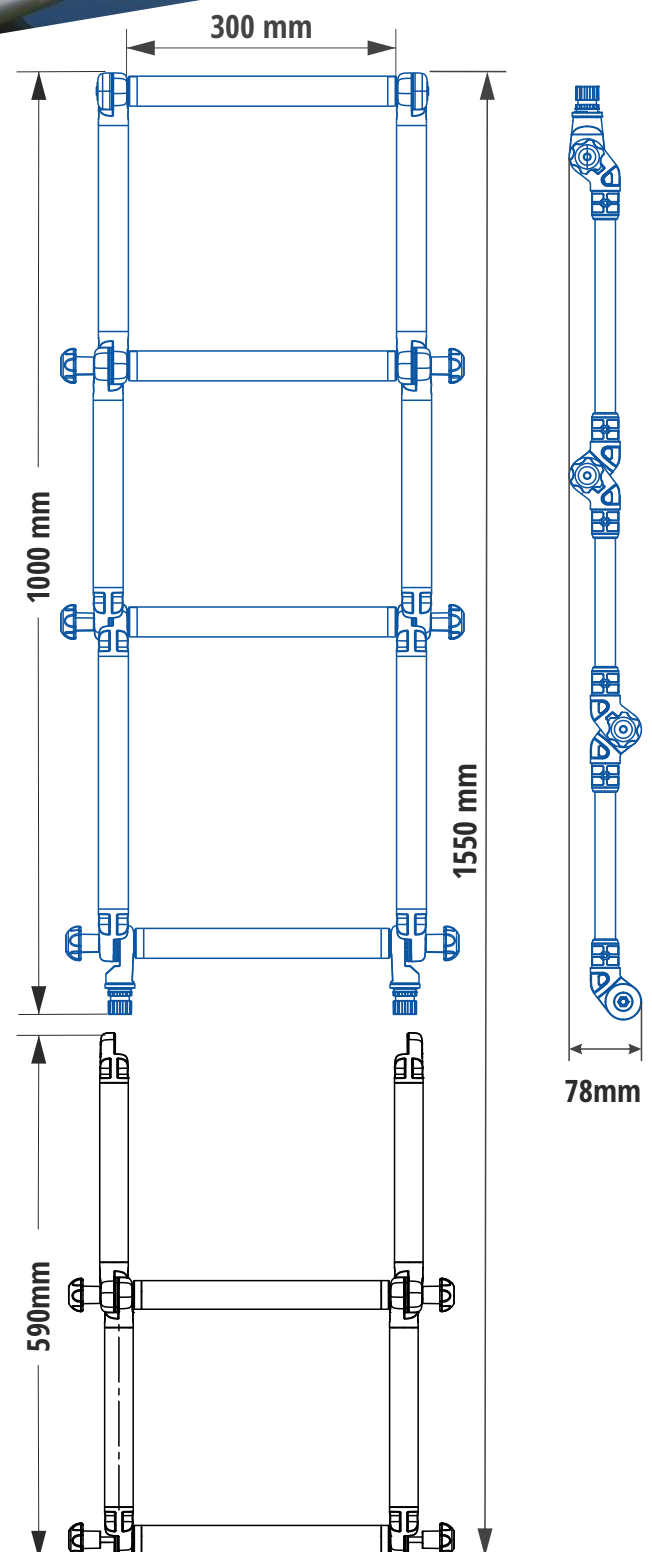

FI022

Folding aluminium tube ladder (Ø22 mm) 1000 mm long with maximum load of 100 kg

1.11.001.01.04

ALA

1.11.001.01.05

ALA

1007*431*78 mm

1780 g

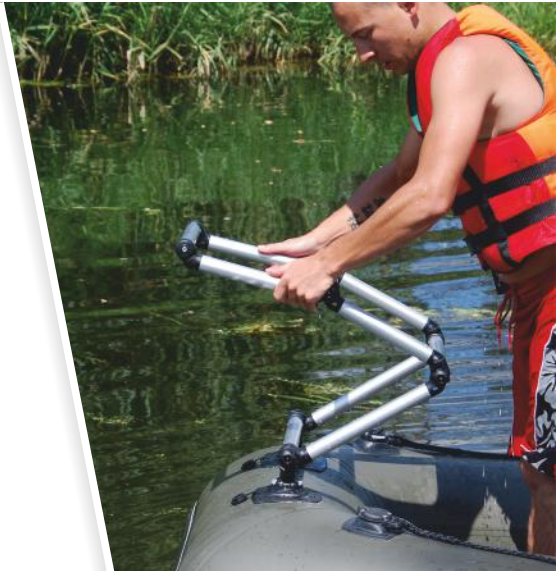

FI032

Folding aluminium tube ladder (Ø32 mm) 1000 mm long with maximum load of 140 kg

1.11.002.01.06

ALP

1.11.002.01.04

ALA

1.11.002.01.05

ALA

1007*431*78 mm

2000 g



EI032

Folding aluminium tube ladder extender (Ø32 mm) 600 mm long

1.11.004.01.06

ALP

1.11.004.01.04

ALA

1.11.004.01.05

ALA

587*432*78 mm



FIp032

Folding aluminium tube ladder with mount kit composed of mounting pads with FMp225 mounts for installation on inflatable PVC cylinder

1.11.002.02.06

ALP

1.11.002.02.04

ALA

1.11.002.02.05

ALA





TI257

Left-hand assembly for tube with external Ø22mm/ internal Ø29mm, used in various designs and has swivel angle on splines with pitch of 7.5 degrees

1.15.007.01.01

1.15.007.01.02

136*72*55 mm

136 g



Tr257

Right-hand assembly for tube with external Ø22mm/ internal Ø29mm, used in various designs and has swivel angle on splines with pitch of 7.5 degrees

1.15.007.03.01

1.15.007.03.02

136*72*55 mm

131 g



TRI257

Left and right-hand assemblies for tube with external Ø22mm/ internal Ø29mm, used in various designs and has swivel angle on splines with pitch of 7.5 degrees, Set of 2 pcs

1.15.007.01.01

1.15.007.01.02

136*72*71 mm

270 g



Tt223

Assembly for tube with external Ø22mm/ internal Ø29mm, used in various designs and has swivel angle on splines with pitch of 27 degrees

1.15.009.01.01

1.15.009.01.02

130*54*39 mm

113 g



Tt193

Assembly for tube with external Ø20mm/ internal Ø29mm, used in various designs and has swivel angle on splines with pitch of 27 degrees

1.15.008.01.01

1.15.008.01.02

130*54*39 mm

113 g



Tt253

Assembly for tube with external Ø25mm/ internal Ø32mm, used in various designs and has swivel angle on splines with pitch of 27 degrees

1.15.010.01.01

1.15.010.01.02

130*55*39 mm

114 g

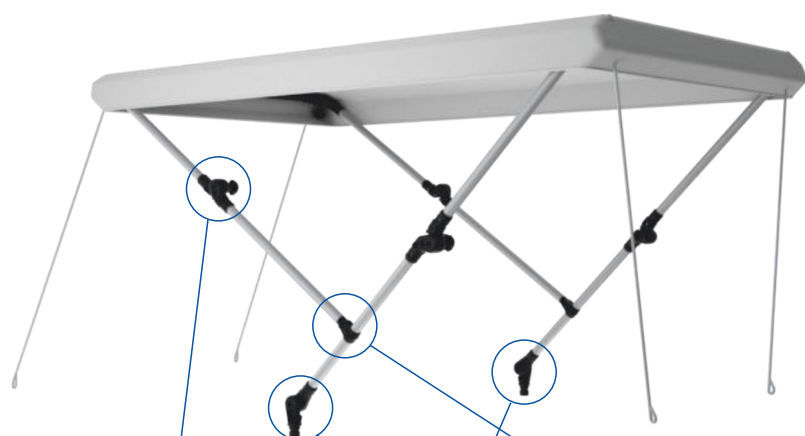

TRI257

Tt223+Av221

Tf022

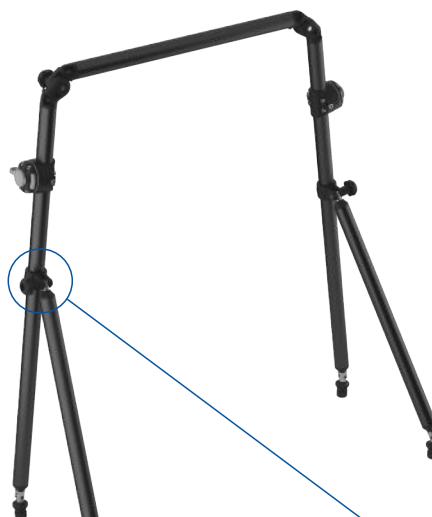

Tf254

Tf032

Rn020**Collar expander
for Ø20 mm tube**

1.15.004.01.01

1.15.004.01.02

**Cn022****Tube collar
Ø 22 mm**

1.15.001.01.01

1.15.001.01.02

1.15.001.01.03

60*53*35 mm

37 g

**Cn032****Tube col
Ø 32 mm**

1.15.002.0.1

1.15.002.0.2

1.15.002.0.3

73*56*35 mm

54 g

**RI032****Collar with adapter
for Ø32 mm tube**

1.15.002.02.01

1.15.002.02.02

107*56*35 mm

116 g

**RI035****Oarlock for oars whose grip
is Ø35 mm, collar allows
for adjustment of oar grip length**

1.15.003.02.01

1.15.003.02.02

**RI032-2****Oarlock for oars whose grip
is Ø32 mm, collar allows
for adjustment of oar grip length,
Set of 2 pcs**

1.15.002.03.01

1.15.002.03.02

**Tc022****Collar with adapter for
Ø22 mm tube that can be used
for making awning frames**

1.15.001.02.01

1.15.001.02.02

1.15.001.02.03

94*53*35 mm

106 g

**Tc022-2****Collar with adapter for Ø22 mm tube
that can be used for making awning frames,
Set of 2 pcs**

1.15.001.2.1

1.15.001.2.2

1.15.001.2.3

**Tf022****Tilt joint with collar for
Ø22 mm tube used for
making awning frames**

1.15.001.04.01

1.15.001.04.02

1.15.001.04.03

82*53*35 mm

53 g

**Tf022-2****Tilt joint with collar for Ø22 mm tube
used for making awning frames, Set of 2 pcs**

1.15.001.05.01

1.15.001.05.02

1.15.001.05.03

**Tf032****Swivel and tilt joint with
collar for Ø32 mm tube used
for making awning frames**

1.15.002.04.01

1.15.002.04.02

115*56*35 mm

121g

**Tf032-2****Swivel and tilt joint with collar for Ø32 mm tube
used for making awning frames, Set of 2 pcs**

1.15.002.05.01

1.15.002.05.02

**Tf255****Cardan joint
Ø22 mm**

1.15.006.01.01

1.15.006.01.02

**Tf254****Cardan joint for awning**

1.15.005.01.01

1.15.005.01.02

1.15.005.01.03

113*32*32 mm

132 g

3D

ANTARCTIC EXPEDITION

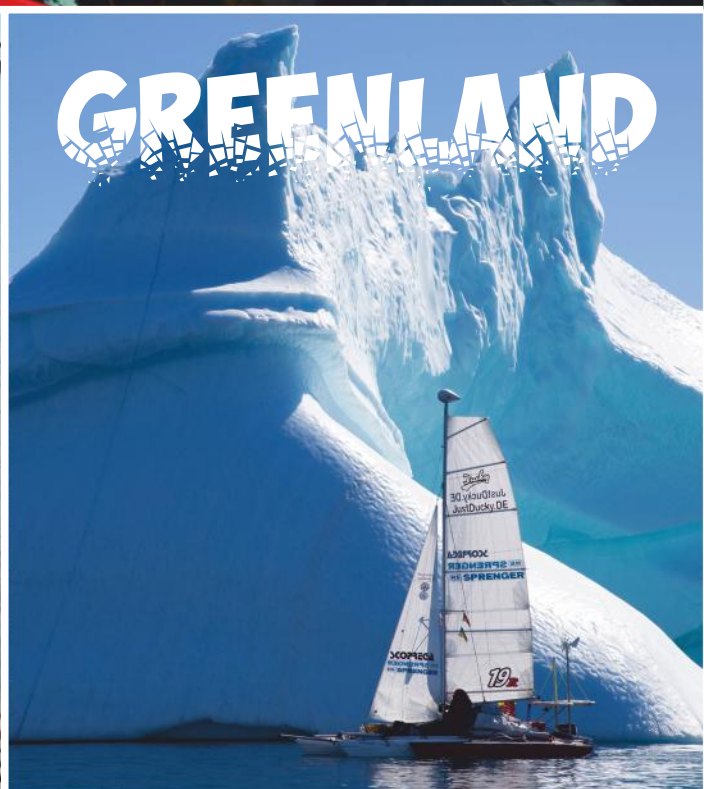

Bering strait

mammoth-expedition.com

Aa221

Universal adapter
with axial bore of 8 mm

1.13.006.01.01

1.13.006.01.02

36*32*32 mm

12 g



Af221

Mount adapter meant
for individual designing
of products

1.17.011.01.01

1.17.011.01.02

39*32*32 mm

21 g



Ah264

Mount-to-mount adapter
meant to join various
designs with installed
mounts

1.17.012.01.01

1.17.012.01.02

82*32*32 mm

63 g

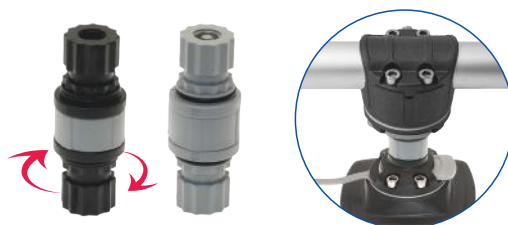

As221

Swivel assembly designed
for modernization and additional
swivel function with pitch of 7.5
degrees both in axis of mount and
tilt toward it

1.17.013.01.01

1.17.013.01.02

112*39*32 mm

96 g



As221-2

Swivel assembly designed for
modernization and additional swivel
function with pitch of 7.5 degrees
both in axis of mount and tilt
toward it, Set of 2 pcs

1.17.013.02.01

1.17.013.02.02



At221

Rigging adapter
with crosshole of 6 mm

1.13.004.01.01

1.13.004.01.02

59*32*32 mm

21 g



Av221

Mount-to-mount adapter
with splined tilt gear with
pitch of 27 degrees

1.17.014.01.01

1.17.014.01.02

1.17.014.01.03

152*70*39 mm

134 g



Rf264

Adapter for Fs219
with link to RAM (RAP-B-366U)
accessories

1.17.015.01.01

1.17.015.01.02

44*32*32 mm

40 g



Rf264-2

Adapter for Fs219
with link to RAM (RAP-B-366U)
accessories, Set of 2 pcs

1.17.015.02.01

1.17.015.02.02



NEW

Ac001

Adapter for Fs219 mount
with threaded joint and lock
nut for "Carp tackle»

1.17.018.01.01

44*32*32 mm

40 g



Dp230

Adapter spacers for tilt angle adjustments
with pitch of 7.5 degrees, Set of 6 pcs

1.17.017.01.01

1.17.017.01.02

39*39*6 mm

26 g

**Hb227**

Strap holder for straps of up to 35 mm wide,
installed for Fs219 mount,
2 pcs

1.17.008.01.01

1.17.008.01.02

115*63*22 mm

104 g

**Hr227**

Halyard holder for halyards of up to 12 mm in diameter,
installed for Fs219 mount,
2 pcs

1.17.007.01.01

1.17.007.01.02

115*63*21 mm

102 g

**Kn222**

Nut knob

1.17.003.01.01

1.17.003.01.02

37*35*35 mm

24 g

**Kn223**

Screw knob

1.17.004.01.01

1.17.004.01.02

37*35*20 mm

32 g

**Kn224**

Universal handle

1.17.005.01.01

1.17.005.01.02

65*30*21 mm

30 g

**Da230**

Adapter spacers for use with SCOTTY accessories,
Set of 3 pcs

1.17.016.01.01

1.17.016.01.02

39*39*8 mm

9 g

**Kn225**

Nut knob

1.17.006.01.01

1.17.006.01.02

32*32*26 mm

62 g

**Kn226**

Nut knob for C-shaped track FINVAL

1.17.019.01.01

1.17.019.01.02

**Sb038**

Splined and ball joint retainer serving as adapter
between Fs219 mount and
Ø 1.5" / 38 mm ball of RAM mount

1.17.009.01.01

1.17.009.01.02

84*79*47 mm

114 g

**Sb038****RAMmount**

NOTE

LLC BORIKA

Korolenko str. 18, office 8, Kharkov, Ukraine, 61003

Fax: +38 [057] 751-82-18



SCAN QR-CODE AND VISIT
WEB SITE **BORIK.A.UA**



